



Radiate
Positive
Vibes 





Wake Up

and be awesome !

Detoxify. Rejuvenate. Heal. Your energy
refilling station at the heart of the city.

Welcome to **Verve**. A gold rated **green**
building with **Vastu** friendly architecture.



Where the zing of Tolly meets the finesse of Alipore !

1.5 acres gated community living | Twin towers | B+G+12 | 2/3/4 BHK | BU : 669 - 1553 sq ft

Elevated club house on the podium | Pre-certified Gold rated Green Homes



Your private chat room with nature !

The **private terrace at Verve** provides you exclusive privacy, a super wide angle view of the city and the greens and plenty of happy winds of South Kolkata.



Poolside rendezvous !

Swimming pool with deck at podium level | Kids pool | Changing room with showers

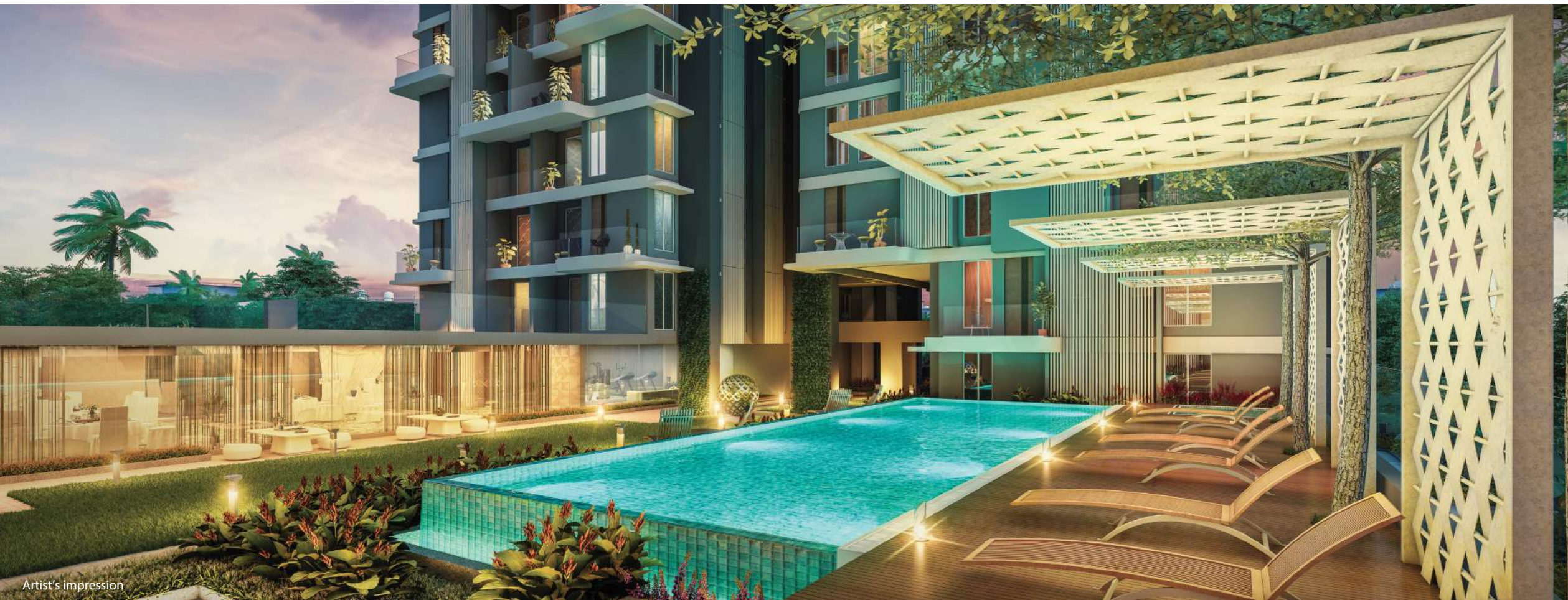

Artist's impression

Feel the vibe !



Multi-purpose sports arena



Meditation zone



Rooftop BBQ



Well-equipped AC gymnasium



Sprawling banquet hall



Tuition kiosk



Kids' play area



Artist's impression



Master Plan

LEGENDS

- ① ENTRY
- ② PERGOLA
- ③ SECURITY ROOM
- ④ SITTING AREA
- ⑤ MULTI-PURPOSE SPORTS ARENA
- ⑥ OPEN CAR PARKING AREA
- ⑦ DROP OFF
- ⑧ DRIVEWAY

1st Floor Plan | Block 1 and 2



BLOCK 2

BLOCK 1

BLOCK 2

| Unit info | | Total flat area sq.ft. | Flat area sq.ft. | Cupboard area sq.ft. | Balcony/Ser. Balcony area sq.ft. | Open terrace area sq.ft. |
|-----------|-----------|------------------------|------------------|----------------------|----------------------------------|--------------------------|
| Flat No. | Flat Type | BU | Carpet | Carpet | Carpet | Carpet |
| I | 3BHK+2TOI | 949 | 787 | 38 | 43 | 0 |
| J | 3BHK+2TOI | 986 | 811 | 41 | 42 | 0 |
| E | 2BHK+2TOI | 684 | 575 | 14 | 39 | 0 |
| F | 3BHK+2TOI | 1041 | 730 | 27 | 39 | 345 |

BLOCK 1

| Unit info | | Total flat area sq.ft. | Flat area sq.ft. | Cupboard area sq.ft. | Balcony/Ser. Balcony area sq.ft. | Open terrace area sq.ft. |
|-----------|-----------|------------------------|------------------|----------------------|----------------------------------|--------------------------|
| Flat No. | Flat Type | BU | Carpet | Carpet | Carpet | Carpet |
| K | 2BHK+2TOI | 795 | 650 | 27 | 43 | 0 |
| J | 3BHK+2TOI | 986 | 811 | 41 | 42 | 0 |
| E | 2BHK+2TOI | 684 | 575 | 14 | 39 | 0 |
| H | 3BHK+2TOI | 1041 | 730 | 27 | 39 | 345 |

*Built up area includes Carpet area of the Unit, Cupboard, Balcony/Ser. Balcony, 50% of the Terrace area and the wall area covering the unit.

Block 1 | 3rd, 6th, 9th and 12th Floor Plan



| Unit info | | Total flat area sq.ft. | Flat area sq.ft. | Cupboard area sq.ft. | Balcony/Ser. Balcony area sq.ft. | Open terrace area sq.ft. |
|-----------|-----------|------------------------|------------------|----------------------|----------------------------------|--------------------------|
| Flat No. | Flat Type | BU | Carpet | Carpet | Carpet | Carpet |
| A | 3BHK+2TOI | 967 | 793 | 38 | 43 | 43 |
| B | 2BHK+2TOI | 700 | 575 | 0 | 41 | 45 |
| C | 4BHK+3TOI | 1553 | 1254 | 41 | 88 | 112 |
| D | 2BHK+2TOI | 698 | 575 | 0 | 39 | 45 |
| E | 2BHK+2TOI | 692 | 575 | 0 | 39 | 45 |
| H | 3BHK+2TOI | 890 | 730 | 25 | 39 | 43 |
| G | 3BHK+2TOI | 890 | 730 | 25 | 39 | 43 |



*Built up area includes Carpet area of the Unit, Cupboard, Balcony/Ser. Balcony, 50% of the Terrace area and the wall area covering the unit.

Block 1 | 4th, 7th and 10th Floor Plan



| Unit info | | Total flat area sq.ft. | Flat area sq.ft. | Cupboard area sq.ft. | Balcony/Ser. Balcony area sq.ft. | Open terrace area sq.ft. |
|-----------|-----------|------------------------|------------------|----------------------|----------------------------------|--------------------------|
| Flat No. | Flat Type | BU | Carpet | Carpet | Carpet | Carpet |
| A | 3BHK+2TOI | 945 | 793 | 38 | 43 | 0 |
| B | 2BHK+2TOI | 677 | 575 | 0 | 41 | 0 |
| C | 4BHK+3TOI | 1497 | 1254 | 41 | 88 | 0 |
| D | 2BHK+2TOI | 675 | 575 | 0 | 39 | 0 |
| E | 2BHK+2TOI | 669 | 575 | 0 | 39 | 0 |
| H | 3BHK+2TOI | 868 | 730 | 25 | 39 | 0 |
| G | 3BHK+2TOI | 868 | 730 | 25 | 39 | 0 |

*Built up area includes Carpet area of the Unit, Cupboard, Balcony/Ser. Balcony, 50% of the Terrace area and the wall area covering the unit.



Block 2 | 2nd Floor Plan



| Unit info | | Total flat area sq.ft. | Flat area sq.ft. | Cupboard area sq.ft. | Balcony/Ser. Balcony area sq.ft. | Open terrace area sq.ft. |
|-----------|-----------|------------------------|------------------|----------------------|----------------------------------|--------------------------|
| Flat No. | Flat Type | BU | Carpet | Carpet | Carpet | Carpet |
| I | 3BHK+2TOI | 961 | 787 | 38 | 43 | 46 |
| J | 3BHK+2TOI | 1008 | 811 | 41 | 42 | 43 |
| D | 2BHK+2TOI | 1005 | 575 | 14 | 39 | 632 |
| E | 2BHK+2TOI | 704 | 575 | 14 | 39 | 41 |
| F | 3BHK+2TOI | 888 | 730 | 25 | 39 | 41 |
| G | 3BHK+2TOI | 1263 | 730 | 25 | 39 | 789 |

*Built up area includes Carpet area of the Unit, Cupboard, Balcony/Ser. Balcony, 50% of the Terrace area and the wall area covering the unit.

Block 2 | 5th, 8th and 11th Floor Plan



| Unit info | | Total flat area sq.ft. | Flat area sq.ft. | Cupboard area sq.ft. | Balcony/Ser. Balcony area sq.ft. | Open terrace area sq.ft. |
|-----------|-----------|------------------------|------------------|----------------------|----------------------------------|--------------------------|
| Flat No. | Flat Type | BU | Carpets | Carpets | Carpets | Carpets |
| A | 3BHK+2TOI | 957 | 793 | 27 | 43 | 45 |
| B | 2BHK+2TOI | 698 | 575 | 0 | 41 | 42 |
| C | 4BHK+3TOI | 1508 | 1254 | 30 | 88 | 43 |
| D | 2BHK+2TOI | 696 | 575 | 0 | 39 | 41 |
| E | 2BHK+2TOI | 690 | 575 | 0 | 39 | 41 |
| F | 3BHK+2TOI | 889 | 730 | 25 | 39 | 41 |
| G | 3BHK+2TOI | 889 | 730 | 25 | 39 | 41 |

*Built up area includes Carpet area of the Unit, Cupboard, Balcony/Ser. Balcony, 50% of the Terrace area and the wall area covering the unit.



VERVE

positive life, positive lifestyle

Grand Entrance Lobby : Well-decorated entrance lobby with premium textured paint finish in common areas such as staircases

Elevation : An iconic building, meticulously designed | Combination of anti-fungal and textured paint

Air-conditioning : Split air-conditioning in all rooms including the dining/living room (not in bathroom)

Foundation & Structure : Reinforced cement with concrete on piles and sheer walls wherever necessary | Strict surveillance on quality

Wall Finish : Putty finish smooth walls

Doors : Internal doors - Both side painted door | Main door - One side teak finish door

Windows : Color anodised or powder coated glazed aluminum windows*

Hardware & Fittings : Branded locks and hardware fittings of Yale, Godrej or equivalent make

Floors & Dado : Large 800x800 vitrified flooring in living and dining, and 600x600 vitrified tiles in all bedrooms | Anti-skid ceramic tiles in kitchen floors, Anti-skid floor tiles in bathroom and designer tiles on walls upto 8 feet height

Elevators : High speed automatic lifts of Kone/Schneider/equivalent make with well-decorated lift cars

Common Lighting : Overhead illumination for compound and street lighting inside the complex | Use of LED lighting in major areas to minimize common area power consumption

Electrical Details : PVC conduit pipe with copper wiring, MCBs/ELCBs with sufficient

power points for necessary gadgets | Fire resistant wires with premium modular switches of Crabtree/Havells or equivalent make | Concealed wiring of reputed brands for electricity, telephone, internet etc. inside the apartment | Quality earthing for all electro-mechanical gadgets

Power back-up : Power back-up up to 5 KVA sufficient to run all your electrical gadgets including Air-Conditioners*

24x7 Security & Fire Prevention : Security surveillance facility with CCTV and 24x7 security guards | Fire fighting arrangement as per West Bengal Fire Service recommendation | Smoke detectors with sprinkler system for fire prevention | Required number of evacuation points and refuge platforms for residents' safety along with fire safety alarms Video door phone facility coupled with intercom system

Treatment : Anti-termite treatment during various stages of construction | Thermal insulation treatment for the roof

Water Treatment & Proofing : Each apartment assures 24 x 7 hour treated water supply Superior quality waterproofing wherever necessary

Kitchen : Granite counter top | Dado of ceramic tiles above platform upto 2 feet height Stainless steel sink | Hot and cold water provision | Ceramic wall tiles in utility balcony

Toilets : Water efficient sanitary fixtures (Hindware Italian collection/Kohler or equivalent) | Top-of-the-line international quality fittings of Jaquar or equivalent make Designer large sized wall tiles up to 7 feet height | Anti-skid flooring | Hot and cold water provision

Live amongst Green, Air & Water : Ample open area and greenery all around | Terraces in some apartments to give a blissful feeling | Meticulously planned apartments, two/three sides open with cross-ventilation and adequate daylight





Pronounce your verve for life !



Artist's impression

stay  *positive* 

Site office : 233 B. L. Saha Road, Kolkata - 700053



Head office : Merlin Projects Ltd, 22 Prince Anwar Shah Road, Kolkata - 700 033

Site office : 233 B. L. Saha Road, Kolkata - 700053

www.merlinprojects.verve | Call : 033 3087 1655 | F : 033 4015 4500  <http://facebook.com/MERLINGROUP>

HIRA Registered No. - HIRA/P/KOL/2018/000075 | www.hira.wb.gov.in

Disclaimer: This document is not a legal offering. It only describes the intent & concept of Verve. All the areas / dimensions / layout / elevations / pictures etc. are only indicative and are not as per scale. All the details are subject to change, alteration and modification as per the developer's discretion.